

Adding Alt Text to an Image

Contents of this page

- [Overview of Alt Text](#)
- [Adding Alt Text in the Insert Image Dialog Box](#)
- [Adding Alt Text in the Source Editor](#)
- [Checking Alt Text](#)

Overview of Alt Text

Keep in mind the following points. Credit for the following list goes to <https://webaim.org/techniques/alttext/> .

- Adding alternative text to images is one of the easiest accessibility principles to learn and one of the hardest to master.
- Alternative text may be provided in the `alt` attribute or in the surrounding context of the image.
- Every image must have an `alt` attribute.
- Alternative text *should*:
 - present the **CONTENT** and **FUNCTION** of the image.
 - be succinct.
- Alternative text *should not*:
 - be redundant (be the same as adjacent or body text).
 - use the phrases "image of..." or "graphic of..."
- Appropriate alternative text depends heavily on the image's context.
- Alt text of a functional image (for example, an image within a link) should describe the function as well as the content.
- Decorative images still need an `alt` attribute, but it should be null (`alt=""`).

Adding Alt Text in the Insert Image Dialog Box

Confluence supports adding alternative text in the Image Properties dialog box.

1. In the page you want to change, click **Edit**.
2. Select the image. The image properties panel appears.

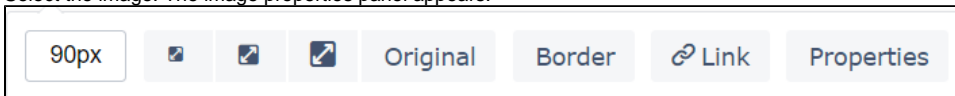

3. Click **Properties**. The Image Properties dialog box appears.

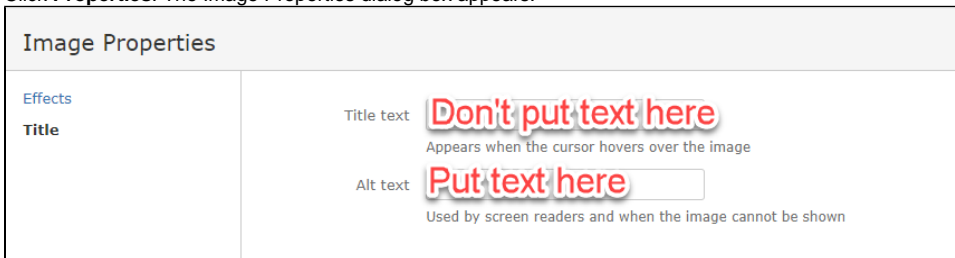

4. In the **Alt text** field, enter alt text. Until [CONFSERVER-34728](#) has been fixed, avoid using the following special characters in alt text:
 - forward slash (/)
 - colon (:)
 - question mark (?)
 - double quote (")
 - semi colon (;)

Do not add text in the Title text field.

Adding Alt Text in the Source Editor

To enter alt text in the Source Editor (XHTML), enter the `ac:alt` attribute in the `ac:image` element as follows.

```
<ac:image ac:alt="caDSR logo">
```

Special characters

Until [CONFSERVER-34728](#) has been fixed, avoid using the following special characters in alt text:

- forward slash (/)
- colon (:)
- question mark (?)
- double quote (")
- semi colon (;)

An image inserted this way has alt text, which is evident to the user of a screen reader for the following image.



Checking Alt Text

To view the alt text, you can display the image properties in your browser. To view alt text inline with the images, consider using a checker such as the WAVE Web Accessibility Evaluation Tool, available at the following site:

<https://wave.webaim.org/> 